



we give you the edge

# Turbo II

## Operations Manual



**Uzin Utz**  
NORTH AMERICA



14705 E 33rd Pl  
Aurora, CO 80011  
(720) 374-4810

**[www.wolfftools.com](http://www.wolfftools.com)**



**we give you the edge**

## **Comes with:**

**Turbo Stripper**  
**Spare blades**  
**Ear protectors**  
**Safety gloves**  
**Tools**  
**Additional weight**  
**Operating manual**

## **1.0 Technical Data**

115V, 60Hz, 3 HP motor, soft start switch, max. working width 6"-14", 5,000 strokes/min, 350 lbs, stripping capacity approx. 645-1075 square feet/hour

## **2.0 CE Declaration of conformity**

We declare under our sole responsibility that this product is in conformity with the following standards of standardization documents: EN 50144, according to the provisions of the Directives 2006/42/EC.

CE Vaihingen/Enz, 01.03.2010

Dipl.-Ing. (FH) Dieter Hammel  
Konstruktionsleitung

i.V. 

WOLFF | Eine Marke der Uzin Utz Gruppe | D-71665 Vaihingen/Enz | Dieselstraße 19

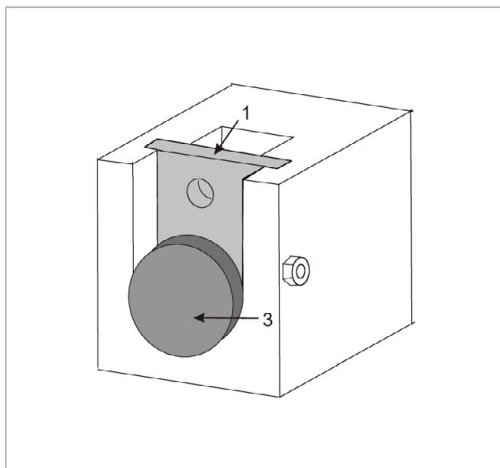

Always wear ear protectors!



## **3.0 Safety instructions**

Disconnect the power supply before any maintenance is carried out. Use only recommended blades and ensure it is sharp before starting.

Maintenance should be undertaken only by qualified personnel. Use only genuine Wolff spare parts.

### **Transport**

To avoid harm or danger, always remove the blade before transporting the machine.

Disconnect the power supply and the plug of the clutch before removing the handle. Otherwise you might damage the hydraulics of the clutch.

Mount the steel plate (1) at the shaft instead of the clutch. Turn thumb screw (3) clockwise until the transport wheels are blocked. Thus the machine cannot move by itself.

Never transport the machine without the wheels blocked.

Using this machine without ear protectors may jeopardize or harm your health. It may harm especially your ears and increase the risk of an accident.

The user and any person not far off should always use ear protectors!



**we give you the edge**

### 3.1 Introduction

This operating manual should be used to get the most benefit from your Turbo-Stripper.

Following these instructions will both extend the life of your machine and reduce repair costs. Please ensure any user of the machine is fully familiar with the instructions for use before allowing work to start.

### 3.2 Danger while working with the machine

The Turbo-Stripper is designed to the highest technical standards. Incorrect use can be dangerous!

Disturbances that could impair safety, have to be eliminated at once.

### 3.3 Restriction of use

The Turbo-Stripper is exclusively for removing bonded floor coverings in dry environments.

It should not be used for any other purpose. Wolff cannot be held responsible for any damage or loss caused by incorrect use.

### 3.4 Genuine Spare Parts

Spare parts and accessories are manufactured uniquely for the Turbo-Stripper. It must be emphasized that parts obtained from unauthorized sources must not be used.

Wolff cannot be held responsible for the performance of or any damage arising from the use of machines in which genuine spare parts have not been used.

This is particularly important with replacement blades.

### 3.5 Low-voltage protection

The Turbo-Stripper is equipped with a low-voltage protection switch. The power supply breaks if current fluctuation or mains power failures occur, thus preventing serious perilous accidents.

Due to the restart protection, the machine will not restart after a power failure, even if the operation switch has not been switched off.

For using the protective cut-out switch see also item 5.0 Application



Use this machine only

- ☐ as instructed in this operating manual
- ☐ with the machine in perfect working order.



Wolff cannot be held responsible for any damage or loss caused by incorrect use. Correct use also includes

- ☐ to take care of all directions from the operating manual and
- ☐ the execution of maintenance and service.



we give you the edge

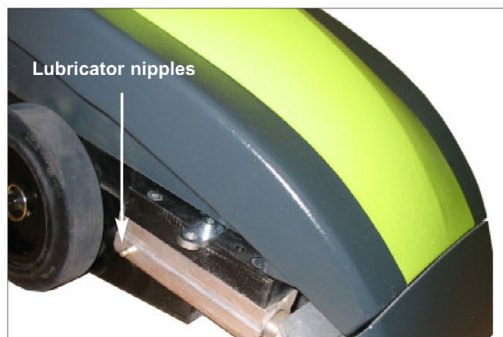

## 4.0 Maintenance

The Turbo Stripper requires very little maintenance. Have the guides of the swing bolts lubricated from time to time (after approx. 500 square meters).

The lubricator nipples are located collateral on the front side (see picture). The used grease will flush dirt out of the machine.

Press maximum 3 to 4 times with the grease gun. Never press too much grease into the machine. Otherwise the mechanism will be blocked.

## Changing the blade

Disconnect the power supply before changing the blade. Use work gloves for your own safety.

- ☐ Put the handle on highest position, (see chapter 5,3)
- ☐ Fold up column and tip the machine
- ☐ put on the blade protection (enclosed in the tools set)  
**Warning!** Very sharp blade! You may cause injury without using the blade protection!
- ☐ secure the tipped machine from tilting over
- ☐ clean and loosen the screws of the blade mounting,  
**Attention!** Set the wrench at a position opposite to the blade to avoid injury.
- ☐ replace the blade.

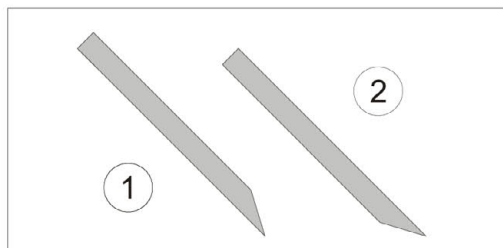

Make sure that the blade fits in exactly into the support. On normal and hard subfloors the bevel of the blade should show upwards (1), on soft subfloors (e.g. chipboards) the bevel should show downwards (2).

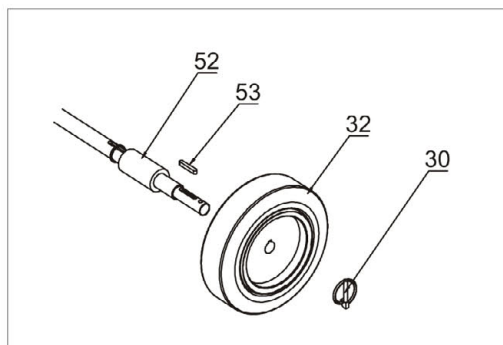

## Changing the driving wheels

Remove the splint-pins and pull the wheels from the axle. Do not loose the springs under any circumstances!

## 5.0 Use

The Turbo-Stripper removes any bonded floor coverings in strips. This procedure corresponds with the customary method of using a hand floor scraper. The stripper works with a thin steel blade at very high frequency, minimizing vibration and noise.

The Turbo-Stripper is self propelled. The motor actuates both the blade and the machine movement. The blade drive starts as soon as the machine is switched on. The hand clutch will engage the drive.





**we give you the edge**

## 5.1 Starting

The Turbo-Stripper is equipped with a power-on indicator lamp and an operating switch. The switch runs off at low-voltage failures.

If the lamp does not indicate power-on, use another power socket or check power supply.

If a mains power failure occurs during operation, switch-on the machine again.

## Preparations

Before starting work, cut the floor covering into strips of about 35 cm (12 inch). You cannot work faster if you cut wider strips.

To begin, cut one strip crosswise.

Then lift the floor slightly in order to get the blade underneath it.

We recommend to cut the first strip at right angles to the main working direction. By so doing access to the adjacent strips is made easier.

Cut the strips smaller if the floor covering is bonded very securely, e.g. with an epoxy adhesive.

The blades are sharpened by the floor pavement. Therefore the blade only has to be changed if it is twisted, collateral rounded or becomes worn.

The driving wheels are subjected to wear. They have to be changed after approximately 16 mm (0.6 inch) of the surface has been worn away. Otherwise the working angle of the striking apparatus will not be correct especially critical with cork or foam backed carpets.

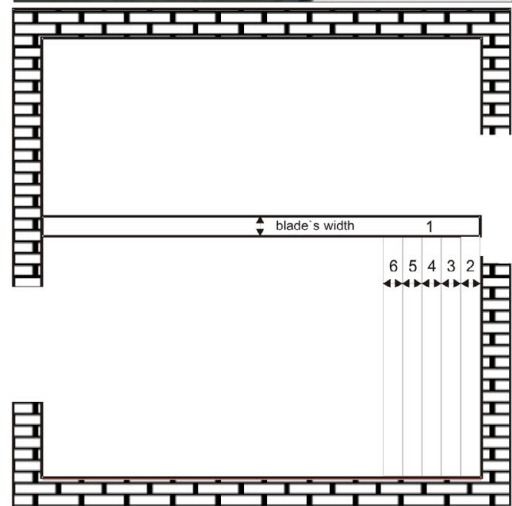
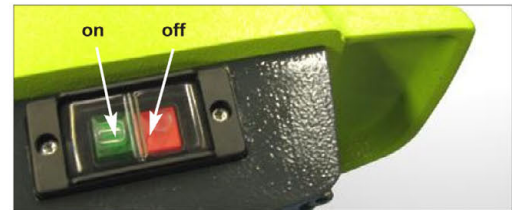

If the machine is switched on, but the hand clutch is not engaged, it might happen that the machine runs slowly "backwards". This is caused by the return stroke of the blade action. It means no failure of the Turbo-Stripper.



pos. ahead      pos. center      pos. backward  
without additional weight      with 3 additional weights

## 5.2 Assembly of support for additional weight (accessory)

Item no. 038535

The weight of the Turbo-Stripper is expandable by 1 up to 3 additional weights (1 single weight = 30 kg).

Individual weight shifting is possible at 3 positions (see picture)."



## 5.3 Adjusting the handle

The height of the handle can be adjusted to adapt the machine to the stature of the operator. To adjust the inclination, loosen the thumb screw at the foot of the handle.

After changing the height of the handle, it may be necessary to readjust the handle attachment of the clutch.





we give you the edge

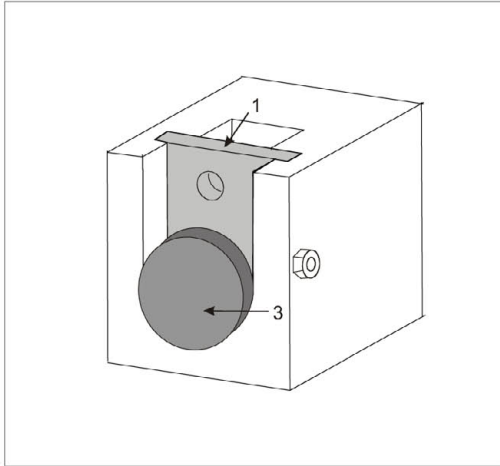

## 5.4 Emergency running

The Turbo-Stripper can be operated also with broken or damaged hand clutch as follows:

- ☐ disconnect power supply
- ☐ remove emergency-run-plate (1) (mounted on top of the plug of the hand clutch (2) )
- ☐ insert emergency-run-plate instead of the plug
- ☐ screw-in thumb-screw (3) until the driving wheels are blocked
- ☐ fix emergency-run-plate with thumb-screw (4)
- ☐ If the emergency-run-plate is mounted, the motor drive is always switched on. The machine starts running immediately after switching on.

## 6.0 Information about certain floor coverings

### Needlepunch felt and tufted carpets on jute hessian backings

Cut into strips of approx. 35 cm (14inch) width. If the flooring is bonded very tight, cut strips smaller. The machine should remove the flooring without slipping wheels.

### Carpets with foam backing

A sharp blade is essential in order to ensure the floor covering is removed together with the foam backing.

Remove floorings across the width, particularly if you have an uneven sub-floor.

### Tiles

Use blade of the same width as the tiles and use a new blade. Tiles above size 30 x 30cm (12 x 12inch) have to be cut into half. If the sub-floor is uneven, use smaller blades.

In all cases, check from time to time to ensure the blade is still sharp. If it is not or any distortion has occurred, replace it immediately.

## 7.0 Trouble Shooting

Trouble	Probable Cause	Solution
Machine does not run	Power supply disconnected blown fuse defective cable or plug	Have machine repaired by a qualified electrician, respective change parts
Undue force necessary or excessive vibration	Blade is blunt	Change blade
Excessive vibration	Expendable parts are worn out	Return machine for service and/or repair

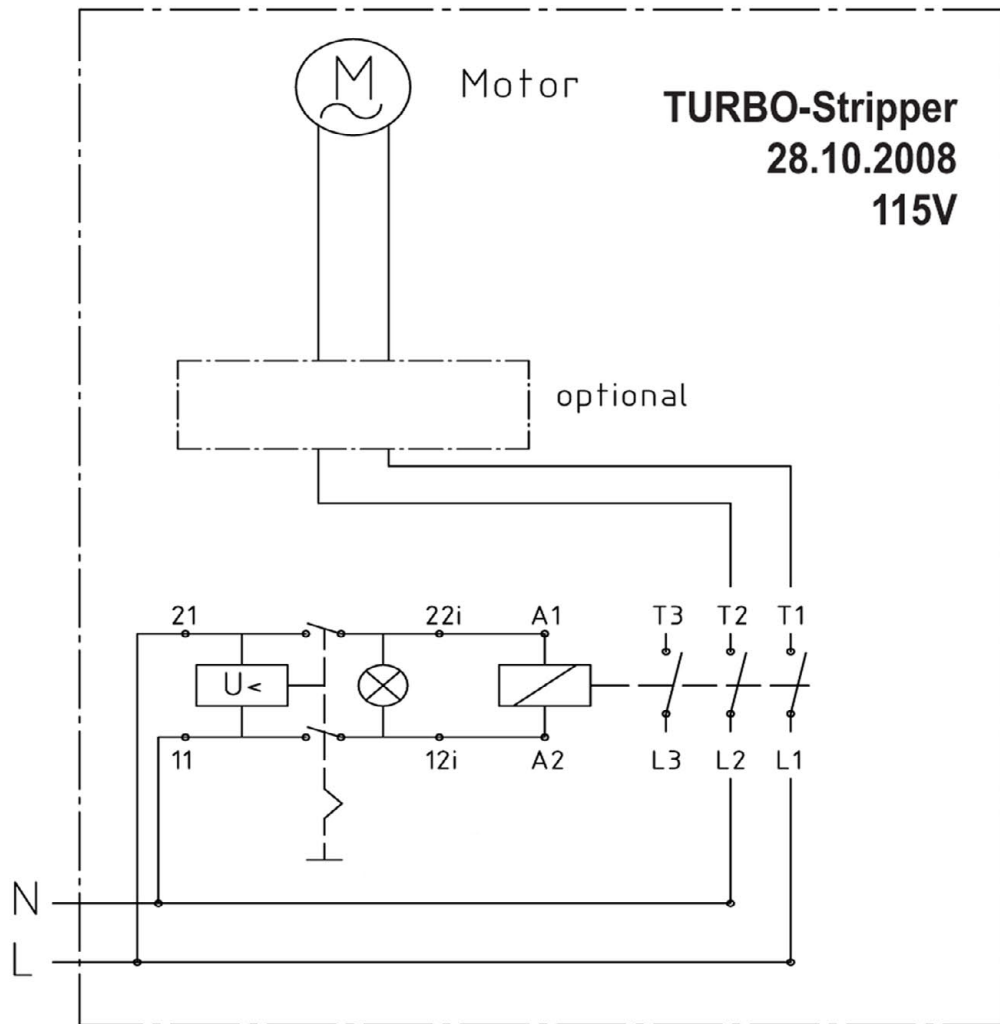

## Accessories

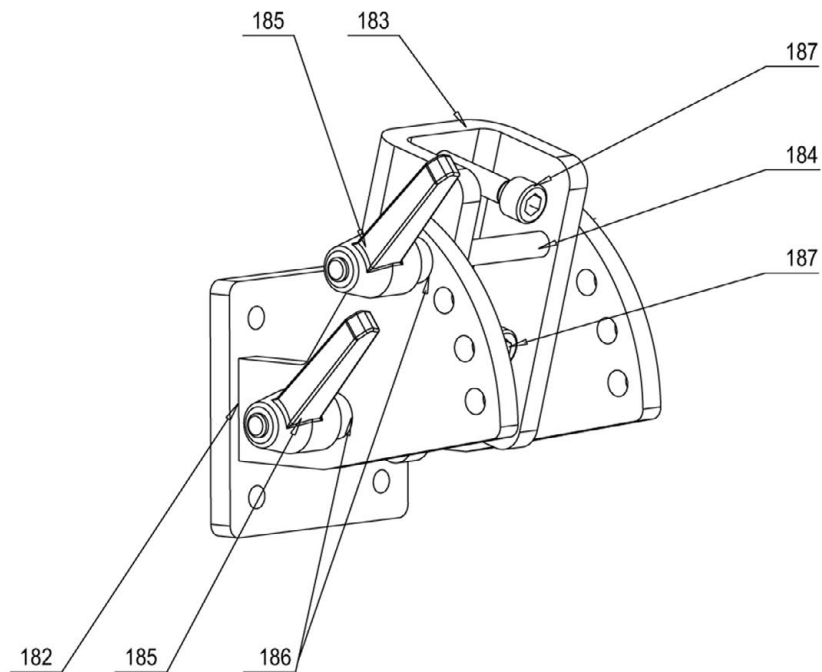







Turbo II Parts List		
Position #	Description	Part#
1	Chassis	015106
2	Suppressor Capacitor	016088
4	Piston block	015054
3	Connecting Block	017623
5	Screw M 8x30	014736
6	Washer, M8	014860
8	Lubricating nipple	014914
9	Connection, Strain Relief	051948
12	Cover	038534
13	Screw M8x25	014735
14	Additional weight	038535
15	Screw M10x80	039234
16	Screw Nut M10	039189
19	Bushing 20x26x20	014909
20	Blade holder	038536
21	Striking foot	015127
22	Screw M8x20	014734
23	Screw M10x25	014763
25	Piston rod	015132
26	Washer M13	014833
27	Screw M12x30	014744
28	Connecting block	015417
30	Wheel pin	014888
31	Washer	014851
32	Drive wheel	015135
33	Gear mounting block	015033
34	Screw M10x45	014741
35	Safety washer M10	014861
36	Clutch holder	040003
37	Clutch stop device	040006
38	Pressure bolt	015120
39	Emergency run unit	043622
41	Pressure spring	040002
42	Pressure Spacer	042681
44	Thread Pin	014791
45	Cylinder pin	014874
46	Washer M6	014859
47	Clutch Disc	015119
48	Gear Block	015140
49	Small drive belt	014938
52	Drive shaft axle	015142
53	Key 5x5x32	014902
54	Gear mounting block left	015036
57	Transport wheel	041888
59	Carriage Bracket	042612
61	Nut key	014904
62	Connecting rod with pin	015144
63	Connecting rod pin only	014875
64	Ball bearing	014710
65	Circlip	014856

66	Circlip	014850
67	Ball bearing	014712
68	Circlip	014853
69	Excenter shaft	015145
70	Nut key	014901
71	Key	014903
72	Circlip	014852
73	Bearing block right/left	017079
75	Screw 10x70	014742
76	Cylinder pin 8x40	014876
77	Motor	015056
78	Drive sprocket	015129
79	Motor Power Cord (2 wire)	014973
79	Motor Power Cord (3 wire)	051919
80	Motor plate	016860
81	Screw m5x25	014721
82	Washer m5	014858
84	Large Drive Belt	014937
85	Handle Bracket	038531
86	Outer tube	038508
87	Inner tube	038509
88	Electrical cord short	014974
89	Clamping Lever	038567
90	Arresting bolt	037953
91	Stopper	018800
92	Cylinder screw M8x25	014735
93	Washer M8	014828
94	Bottom cover	015154
95	Grip	039233
96	Screw M6x12	014799
97	Power cord long	014970
98	Belt pulley	015155
99	Belt pulley	015156
100	Washer	014828
101	Groove ring	014845
102	Hex Bolt M8x22	018153
103	Screw M6x25	014731
104	Washer M12	014862
105	Starter disc	015164
106	Weight Bracket	042741
107	Switch housing	051915
108	Switch housing cover	038505
109	Clamping lever	038566
113	Motor cover	015130
114	Bracket	038606
115	Screw M5x90	014724
116	Bushing 20x26x11	015141
117	Bushing 20x26x30	014910
118	Washer	014835
123	Cable Pit	039188
125	Cylinder screw M4x12	018284
126	Hydraulic clutch assembly	038837
128	Axle	042739

129	Strain Relief	017559
130	See Catalog for blade options	
133	Cover	015107
136	Screw M8x16	017651
137	Washer M4	017452
138	Screw	051914
139	Cylinder screw m6x60	018259
140	Fitting	039190
141	Stop nut m8	014816
142	Belt Pulley	014848
146	Contactor	017439
147	Contactor bracket	020969
148	Cylinder screw M6x105	039284
149	Grip covering	038568
150	Screw M4x8	017473
151	Switch	051710
152	Protection cap	051722
175	Washer	017786
176/177/178	Twist lock assembly	015046
178	Screw only	017701
179	Column	051837
180	Lock washer M10	014844
181	Shoulder bolt	021232
188	Bolt	036272
189	Clamping Bracket for motor (not shown)	014943
190	Fastening plate for motor clamp (not shown)	059467
191	Rubber sleeves (not shown)	059469

	<b>Without Drawing</b>	
	Tool Kit	015162
	Motor brush set	015152
	Bushing for connecting block	014913
	Lifting straps	040603
	Handle complete	039089

	<b>Accessories</b>	
	Tilt Handle Bracket Complete	042366
182	Handle bracket	042365
183	Support handle bracket	042367
184	Hexagon bolt	042369
185	Clamping lever	042473
186	Spring washer	014844





we give you the edge

## Guarantee

The guarantee period for new Wolff machines is **one year** from the time of delivery/transfer to the customer, unless another period applies pursuant to mandatory legal regulations.

When making a claim under guarantee, the invoice and/or proof of purchase must be provided.

All repairs covered by the guarantee must be carried out by a Wolff service shop recognised by us. Repairs which are carried out by the customer and/or improperly automatically lead to a disentanglement from guarantee claims. The same is true of improper operation and/or use.

## Replacement of parts, accessories and other changes to Wolff machines

Wolff machines provide users with a high degree of safety and reliability. To maintain this, the condition of your Wolff machine may not be changed from that on the date it was delivered from the factory without observing the following rules. These rules apply for the replacement of parts, the addition of accessories and other technical changes.

- ☐ All work done on your Wolff machine must be carried out **exclusively by a specialist workshop** which has suitably trained and experienced staff and the working materials required. For this, we recommend an authorised Wolff service shop.
- ☐ In the event that parts are deliberately replaced, accessories are deliberately added or other technical changes are deliberately carried out, the customer must always consult an authorised Wolff service shop or us, the manufacturer, **before starting the work.**
- ☐ We urgently recommend only using safety-checked original Wolff spare parts and original Wolff accessories which have been cleared by us, the manufacturer. These spare parts and accessories can be purchased from your authorised Wolff service shop, which will also be pleased to assemble them for you properly.

Original Wolff spare parts and Wolff accessories have been specially tested for their safety and suitability for Wolff machines.

**We can not sufficiently judge the safety and suitability of spare parts and accessories which are not original Wolff parts, and are thus unable to vouch for them.**

- ☐ To maintain operating reliability and avoid damage, in the case of technical changes – of whatever kind – our **technical guidelines are to be observed** in every case. Please also contact us at any other time if you have any questions about your Wolff machine.

**We hope you understand that we can not assume any liability for damages caused as a result of improper work and/or violation of the above rules.**